

Offices and Business Centre

Situation The property is situated in a prominent position on the west side of Regent Street within a few hundred yards of the town's railway stations. There are bus stops nearby and the town centre is just a few minutes walk away.

Accommodation 'The Regent', is prominently located at the end of a terrace of attractive Edwardian period properties of traditional brick construction under a pitched slated roof. The building has been completely refurbished to suit modern office needs and benefits from:

- Gas Central Heating & Wall Insulation
- Solar Panels
- Triple Glazing
- Fitted Carpeting
- Cat 5 data cabling
- Ample desk height power & telecom sockets
- Intelligent Lighting
- Intercoms
- Monitored Alarm & CCTV
- Secure on-site Parking
- Fitted Communal Kitchen



The **Regent**

67 Regent Street, Wrexham LL11 1PF

a development by

Ebenezer
PROPERTIES 



space to thrive



Office **SqFt** **SqMtr** **Rent PCM*+**

2- Beaumaris 107 9.94 £172

Terms Available by way of a new internal repairing lease for a minimum of 12 months. (All leases will be excluded from the security of tenure provisions of the Landlord & Tenant Act 1954).

Use Class: A2

EPC: Asset Rating B(42), details available upon request.

* Excludes Utilities Services Charge

+Deposits taken for Offices and sets of Keys - returnable on exit should all conditions be met

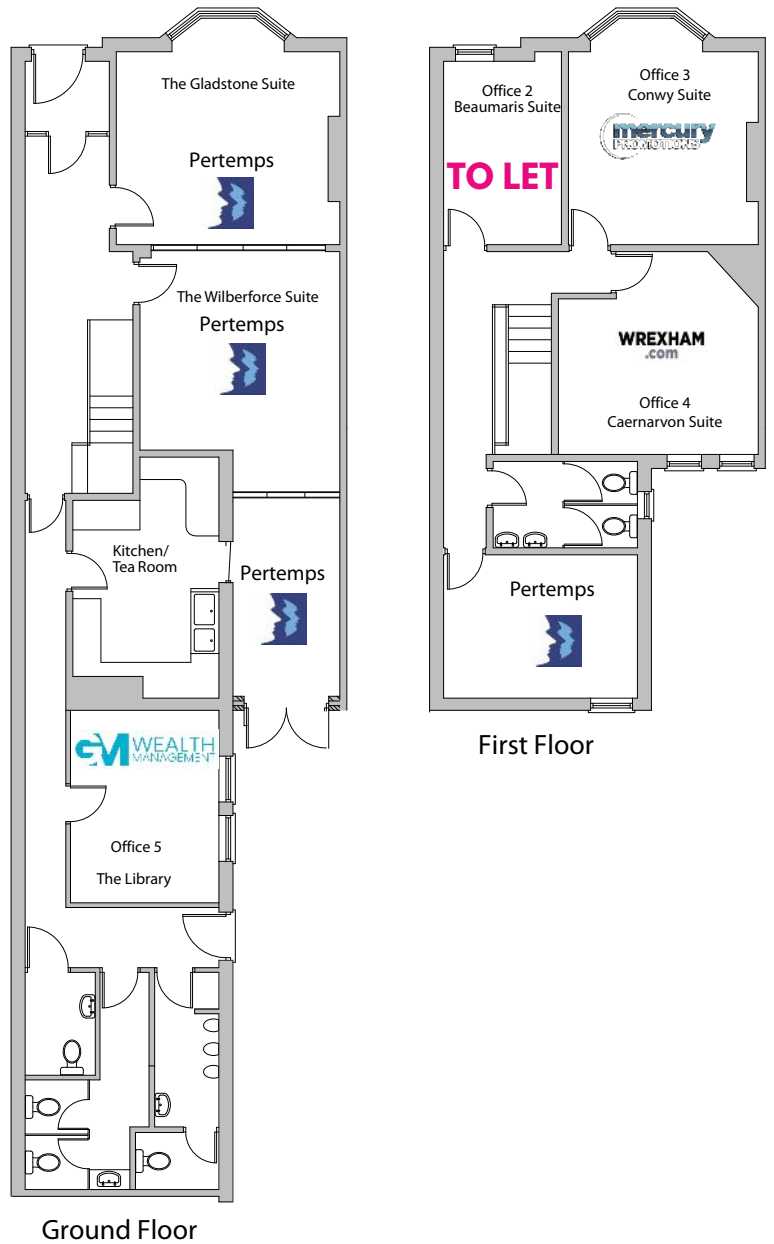

Viewing Strictly by appointment.

thergent-offices-wrexham.co.uk

07786923078

j.kinch@ebenezerproperties.co.uk